



**A**ll  
**A**ccomplishment  
Int'l **C**orp.

Think on a  
global scale





PRODUCE... DELIVER



SELL

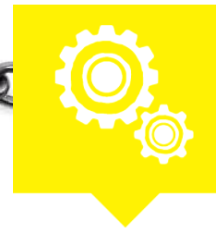

PRODUCE



**All**  
**Accomplishment**  
**Int'l Corp.**

Know The **Customer**  
Know The **Product**  
Know The **Competition**

**We Integrate Optimized Solution for you!!!!**



Patent Parts

Bolt & Screw



Nut

Rivet Nut



Special Parts



## Patent Parts

## Anti-Theft Breakaway Nut



Taiwan: M 482660

Germany: GERMAN UTILITY MODEL NO. 20 2014 008 374

China: CHINESE UTILITY MODEL NO. ZL 201420590456.3

USA: in progress of auditing.



### Material

Carbon steel  
brass/bronze  
Aluminum  
Alloy,  
Stainless

### Specification

M3~M18,  
Length: 140 mm Max.  
Be subject to various **Torque**,  
**Shape** and **spec** of OEM/ODM.

### Feature

Tamper Resistance  
Anti-theft & property secure  
hard to grab it with pliers  
Highly Reliable  
Corrosion Resistance  
Wide Application



# Anti-Theft Breakaway Nut



How it works?



Application

Interior Parts  
&  
Wheel Security





**Safety & Property  
Security**





# Bolt & Screw



## Socket Set Screw

### Flat Point

 DIN913/ISO4026 Size : M1.6~M24 Length : 2~120mm  
ANSI/ASME B18.3 Size : #2~3/4 Length : 1/8~3

 DIN551/ISO4766 Size : M1.6~M12 Length : 2~40mm  
ANSI/ASME B18.3 Size : #4~5/8 Length : 1/8~1-3/4

### Cone Point

 DIN914/ISO4027 Size : M1.6~M24 Length : 2~120mm  
ANSI/ASME B18.3 Size : #2~3/4 Length : 1/8~3

 DIN553/ISO7434 Size : M1.6~M12 Length : 2~40mm  
ANSI/ASME B18.3 Size : #4~5/8 Length : 1/8~1-3/4

### Dog Point

 DIN915/ISO4028 Size : M1.6~M24 Length : 2~120mm  
ANSI/ASME B18.3 Size : #2~3/4 Length : 1/8~3

 DIN417/ISO7435 Size : M1.6~M12 Length : 2~40mm  
ANSI/ASME B18.3 Size : #4~5/8 Length : 1/8~1-3/4

### Cup Point

 DIN916/ISO4029 Size : M1.6~M24 Length : 2~120mm  
ANSI/ASME B18.3 Size : #2~3/4 Length : 1/8~3

 DIN438/ISO7436 Size : M1.6~M12 Length : 2~40mm  
ANSI/ASME B18.3 Size : #4~5/8 Length : 1/8~1-3/4

### Oval Point

 Oval Point Size : M1.6~M24 Length : 2~120mm  
ANSI/ASME B18.3 Size : #2~3/4 Length : 1/8~3

 Oval Point Size : M1.6~M12 Length : 2~40mm  
ANSI/ASME B18.3 Size : #4~5/8 Length : 1/8~1-3/4

### Knurled Cup Point

 knurled Point Size : M3~M24 Length : 2~120mm  
ANSI/ASME B18.3 Size : #2~3/4 Length : 1/8~3

 knurled Point Size : M3~M12 Length : 2~40mm  
ANSI/ASME B18.3 Size : #4~5/8 Length : 1/8~1-3/4

## Material

Alloy Steel : SCM 435(HRC 45~43)

Carbon Steel : C1006~C1022、10B21(8.8)

Stainless Steel : A2(302、304)、A4(316)

Brass : C2600、C2700、C3604

Aluminum : 6011、2011、2024



# MATread Bolt & Screw

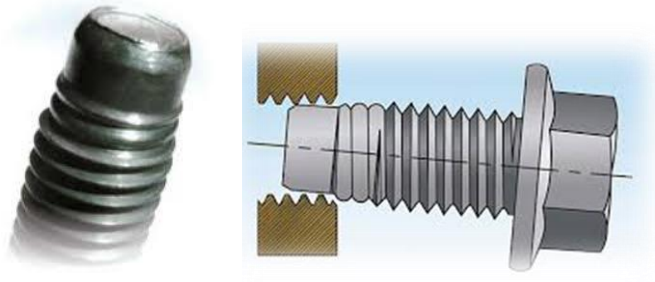

## Material

Carbon Steel 、 Alloy

## Specification

M3 ~ M16 ( #5 ~ 5/8" )

Length: 12 mm ~ 90 mm, 1/2" ~ 3 1/2"

## REMARK

**Very Short M Point** for Limited applications where point clearance is a problem and angular mis-alignment is limited.  
Kindly Note that the part may very rarely jam if installed at over **8°** angular misalignment.



MATpoint

General usage.  
Wide Application.  
When prying heavy component into place during installation – Please use a '**Dog point**' MAThread instead.



MAThread  
Dog point

Special usage.  
For very **difficult** application while prying components into place during installation



MAThread  
P Point

General usage.  
For used with thick stack-ups of multiple components.



MAThread  
Radiused Point

Special usage  
Subject to Design Criteria in special applications



## Triangular Screw Thread

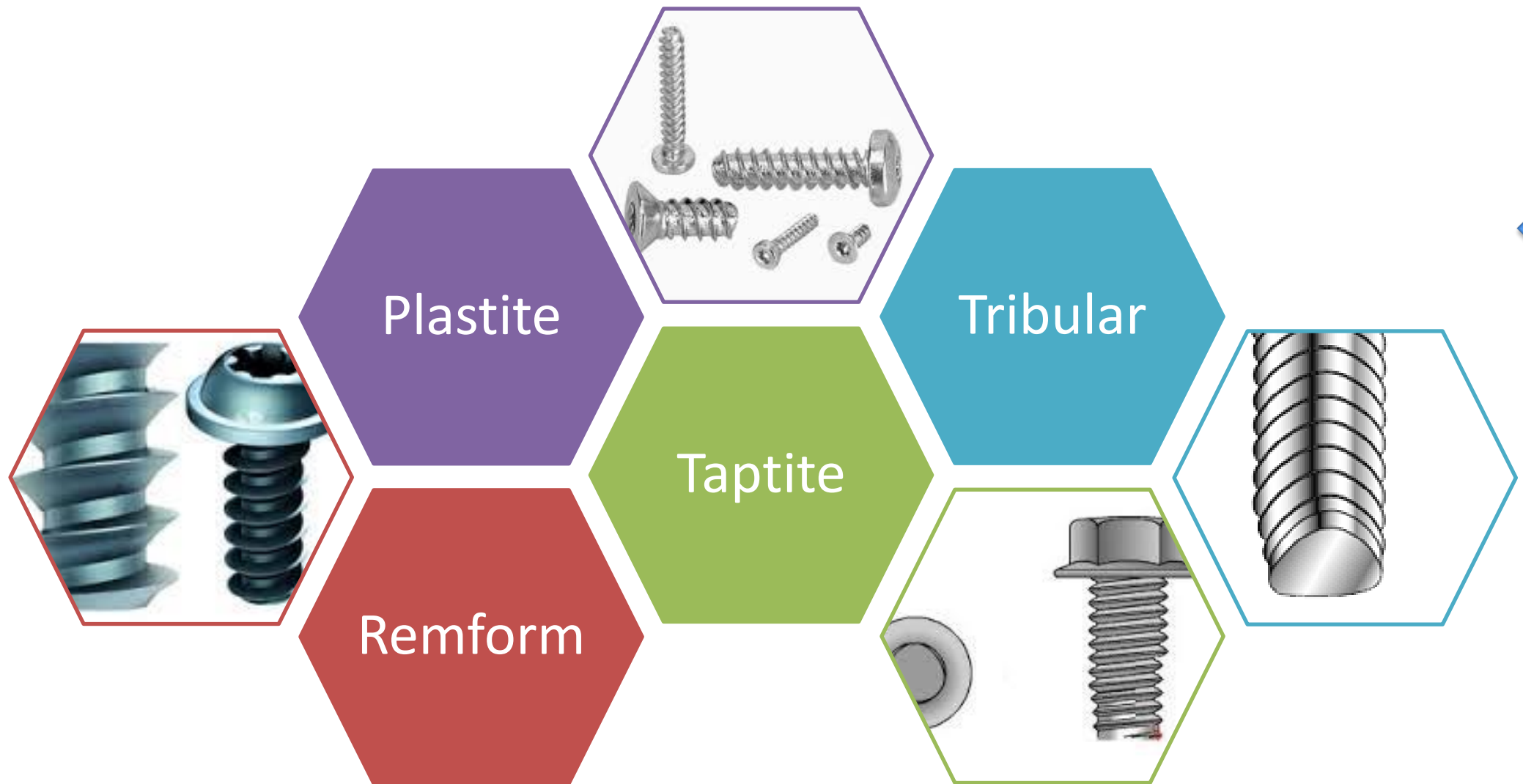

## Torx / Torx Plus Screw



TORX



TORX-PLUS



## Micro / Micro Stix Screw



## Welding Screw



## Clinching Screw



## SEMS Screw







## Material

Alloy Steel : SCM 435(HRC 45~43)  
Carbon Steel : C1006~C1022、10B21(8.8)  
Stainless Steel : A2(302、304)、A4(316)  
Brass : C2600、C2700、C3604  
Aluminum : 6011、2011、2024

## Specification

M2~M18, **Customized Spec** is available!!

### Weld Nut



### T Nut w/Knurl



### T Nut



Hex  
Nylon  
Nut



Flange  
Nut



## Production Equipment & Capacity

Equipment	Bolt & Screw	Nut
Heading Machine	22	16
Threading Machine	13	26
Optical Sorting	10	3
Capacity(Tons/Month)	600	1000

## Nut Production





## Optical Sorting Machines



13







2.5D projector

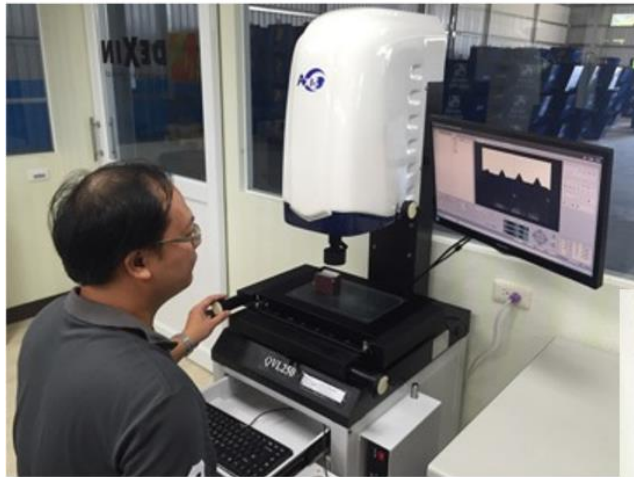

Cutting & Grinding Machine



X-Ray ( plating thickness tester)

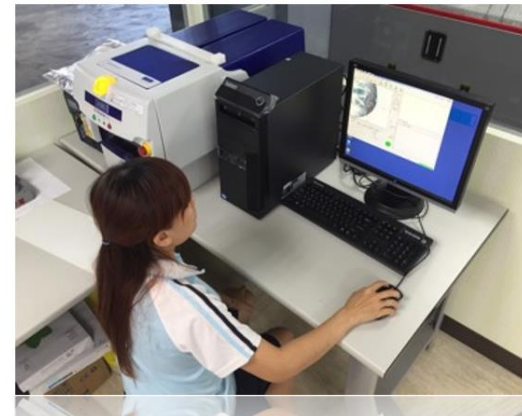

Management system as per  
**ISO/TS 16949:2009**  
(3rd edition, 2009-06-15)

standard has been furnished and is certified for



# Rivet Nut



## Specification

## Material

Alloy Steel : SCM 435(HRC 45~43)

Carbon Steel : C1006~C1022 、 10B21(8.8)

Stainless Steel : A2(302 、 304) 、 A4(316)

Brass : C2600 、 C2700 、 C3604

Aluminum : 6011 、 2011 、 2024

**Customized Project is very welcome!!!**



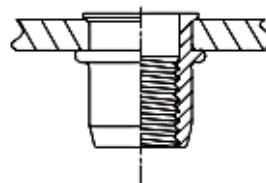
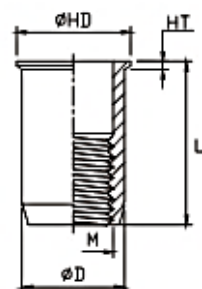

## EUS,USS SERIES

## SMALL FLANGE , OPEN END ( ~K = Knurled )

PART NO.	THREAD SIZE	HOLE SIZE +0.1 / -0.0	D(mm) +0.0 / -0.1	L(mm) $\pm 0.4$	HD(mm) $\pm 0.3$	HT(mm) +0.15 / -0.05	GRIP RANGE
EUSM3/EUSM3K	M3X0.5	5.10	5.0	9.0	6.0	0.5	0.5~2.0
EUSM4/EUSM4K	M4X0.7	6.10	6.0	10.0	7.0	0.5	0.5~2.5
EUSM5/EUSM5K	M5X0.8	7.10	7.0	12.0	8.0	0.5	0.5~2.5
EUSM6/EUSM6K	M6X1.0	9.10	9.0	15.0	10.0	0.5	1.0~4.0
EUSM8/EUSM8K	M8X1.25	11.10	11.0	16.0	12.0	0.5	1.0~4.0
EUSM10/EUSM10K	M10X1.5	13.10	13.0	18.6	14.0	0.5	1.0~4.0
PART NO.	THREAD SIZE	HOLE SIZE +0.1 / -0.0	D(mm) +0.0 / -0.1	L(mm) $\pm 0.4$	HD(mm) $\pm 0.3$	HT(mm) +0.15 / -0.05	GRIP RANGE
USSM3/USSM3K	M3X0.5	4.9	4.8	9.0	5.8	0.5	0.5~2.0
USSM4/USSM4K	M4X0.7	6.4	6.3	10.0	7.3	0.5	0.5~2.5
USSM5/USSM5K	M5X0.8	7.2	7.1	12.0	8.1	0.5	0.5~2.5
USSM6/USSM6K	M6X1.0	9.6	9.5	15.0	10.5	0.5	1.0~4.0
USSM8/USSM8K	M8X1.25	10.6	10.5	16.0	11.5	0.5	1.0~4.0
USSM10/USSM10K	M10X1.5	12.8	12.7	18.0	13.7	0.5	1.0~4.0
PART NO.	THREAD SIZE	HOLE SIZE +0.004 / -0.0	D(inch) +0.0 / -0.004	L(inch) $\pm 0.015$	HD(inch) $\pm 0.012$	HT(inch) +0.006 / -0.002	GRIP RANGE
USS440/USS440K	UNC4-40	.192	.188	.355	.228	.02	0.02~0.08
USS632/USS632K	UNC6-32	.253	.249	.409	.289	.02	0.02~0.10
USS832/USS832K	UNC8-32	.253	.249	.409	.289	.02	0.02~0.10
USS1024/USS1024K	UNC10-24	.284	.280	.464	.320	.02	0.02~0.10
USS1032/USS1032K	UNF10-32	.284	.280	.464	.320	.02	0.02~0.10
USS420/USS420K	UNC1/4-20	.378	.374	.575	.414	.02	0.04~0.15
USS518/USS518K	UNC5/16-18	.420	.414	.630	.456	.02	0.04~0.15
USS616/USS616K	UNC3/8-16	.504	.500	.708	.540	.02	0.04~0.16

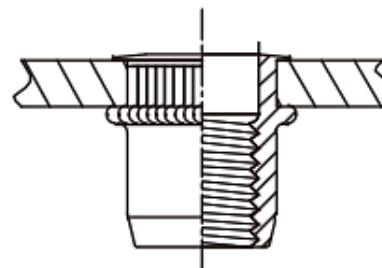
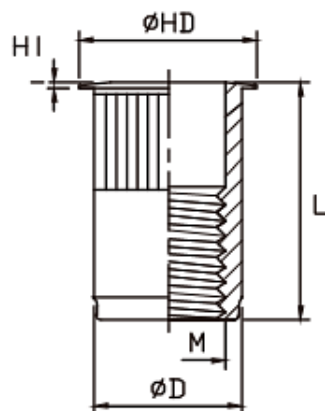

## AS SERIES SMALL FLANGE , OPEN END ( Knurled )

PART NO.	THREAD SIZE	HOLE SIZE +0.1 / -0.0	D(mm) +0.0 / -0.1	L(mm) $\pm 0.4$	HD(mm) $\pm 0.3$	HT(mm) +0.15 / -0.05	GRIP RANGE
ASM4	M4X0.7	6.8	6.75	11.45	7.87	0.48	0.5~2.0
ASM5	M5X0.8	7.6	7.55	12.85	8.64	0.48	0.5~3.3
ASM6	M6X1.0	10.0	9.90	15.50	11.50	0.55	0.7~4.0
ASM8	M8X1.25	13.5	13.45	18.30	15.11	0.55	0.7~4.0
ASM10	M10X1.5	13.5	13.45	18.30	15.11	0.55	0.7~4.0
PART NO.	THREAD SIZE	HOLE SIZE +0.004 / -0.0	D(inch) +0.0 / -0.004	L(inch) $\pm 0.015$	HD(inch) $\pm 0.012$	HT(inch) +0.006 / -0.002	GRIP RANGE
AS632	UNC 6-32	.266	.265	.450	.295	.019	0.02~0.08
AS832	UNC 8-32	.266	.265	.450	.295	.019	0.02~0.08
AS1024	UNC 10-24	.297	.296	.505	.326	.019	0.02~0.13
AS1032	UNF 10-32	.297	.296	.505	.326	.019	0.02~0.13
AS420	UNC 1/4-20	.391	.390	.610	.420	.022	0.027~0.150
AS518	UNC 5/16-18	.531	.530	.720	.560	.022	0.027~0.150
AS616	UNC 3/8-16	.531	.530	.720	.560	.022	0.027~0.150

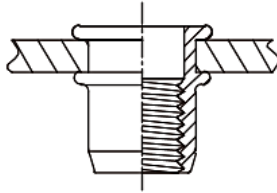
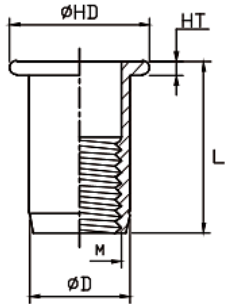

### EUB,USB SERIES FLAT HEAD, OPEN END ( ~K = Knurled )

PART NO.	THREAD SIZE	HOLE SIZE +0.1 / -0.0	D(mm) +0.0 / -0.1	L(mm) ±0.4	HD(mm) ±0.3	HT(mm) +0.15 / -0.05	GRIP RANGE
EUBM3/EUBM3K	M3X0.5	5.10	5.0	9.8	8.0	0.8	0.5~2.0
EUBM4/EUBM4K	M4X0.7	6.10	6.0	11.3	9.0	0.8	0.5~2.5
EUBM5/EUBM5K	M5X0.8	7.10	7.0	12.5	10.0	1.0	0.5~2.5
EUBM6/EUBM6K	M6X1.0	9.10	9.0	16.0	13.0	1.5	1.0~3.5
EUBM8/EUBM8K	M8X1.25	11.10	11.0	18.0	14.5	1.5	1.0~4.0
EUBM10/EUBM10K	M10X1.5	13.10	13.0	21.6	16.0	1.6	1.0~4.0
PART NO.	THREAD SIZE	HOLE SIZE +0.004 / -0.0	D(inch) +0.0 / -0.004	L(inch) ±0.015	HD(inch) ±0.012	HT(inch) +0.006 / -0.002	GRIP RANGE
USB440/USB440K	UNC 4-40	.201	.197	.386	.315	.032	0.02~0.08
USB832/USB832K	UNC 8-32	.240	.236	.445	.354	.032	0.02~0.10
USB1024/USB1024K	UNC 10-24	.280	.276	.493	.393	.040	0.02~0.10
USB420/USB420K	UNC 1/4-20	.358	.354	.630	.512	.059	0.04~0.14
USB518/USB518K	UNC 5/16-18	.437	.433	.709	.571	.059	0.04~0.16
USB616/USB616K	UNC 3/8-16	.516	.512	.850	.630	.063	0.04~0.16

### AB SERIES LARGE FLANGE, OPEN END ( Knurled )

PART NO.	THREAD SIZE	HOLE SIZE +0.1 / -0.0	D(mm) +0.0 / -0.1	L(mm) ±0.4	HD(mm) ±0.3	HT(mm) +0.15 / -0.05	GRIP RANGE
ABM4	M4X0.7	6.8	6.75	11.70	9.5	0.76	0.5~2.0
ABM5	M5X0.8	7.6	7.55	13.10	10.10	0.76	0.5~3.3
ABM6	M6X1.0	10.0	9.90	15.75	12.70	0.76	0.7~4.0
ABM8	M8X1.25	13.5	13.45	18.65	17.00	0.89	0.7~4.0
ABM10	M10X1.5	13.5	13.45	18.65	17.00	0.89	0.7~4.0
PART NO.	THREAD SIZE	HOLE SIZE +0.004 / -0.0	D(inch) +0.0 / -0.004	L(inch) ±0.015	HD(inch) ±0.012	HT(inch) +0.006 / -0.002	GRIP RANGE
AB632	UNC 6-32	.266	.265	.460	.375	.03	0.02~0.08
AB832	UNC 8-32	.266	.265	.460	.375	.03	0.02~0.08
AB1024	UNC 10-24	.297	.296	.515	.400	.03	0.02~0.13
AB1032	UNF 10-32	.297	.296	.515	.400	.03	0.02~0.13
AB420	UNC 1/4-20	.391	.390	.620	.500	.03	0.027~0.150
AB518	UNC 5/16-18	.531	.530	.735	.670	.035	0.027~0.150
AB616	UNC 3/8-16	.531	.530	.735	.670	.035	0.027~0.150

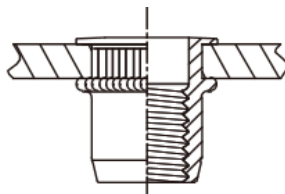
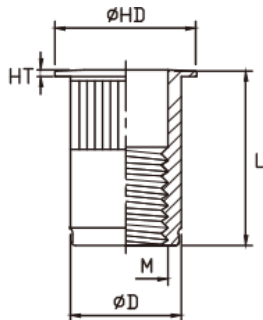



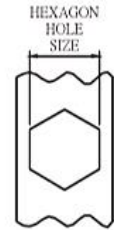
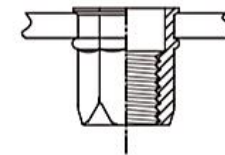
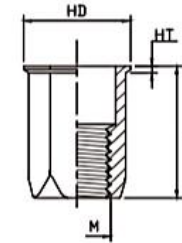

### HS SERIES SMALL FLANGE , OPEN END

PART NO.	THREAD SIZE	HOLE SIZE +0.1 / -0.0	D(mm) +0.0 / -0.1	L(mm) ±0.4	HD(mm) ±0.3	HT(mm) +0.15 / -0.05	GRIP RANGE
HSM4	M4X0.7	6.1	5.9	10.2	6.9	0.5	0.5~2.5
HSM5	M5X0.8	7.1	6.9	12.0	7.8	0.5	0.5~3.0
HSM6	M6X1.0	9.1	8.9	15.2	10.0	0.5	0.5~3.3
HSM8	M8X1.25	11.1	10.9	17.8	12.0	0.6	0.5~3.3
HSM10	M10X1.5	13.1	12.9	21.0	14.6	0.8	0.5~3.5

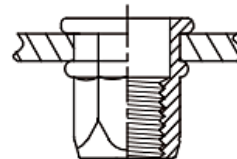
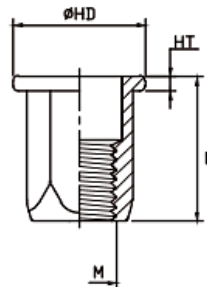
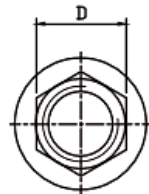

### HB SERIES FLAT HEAD, OPEN END

PART NO.	THREAD SIZE	HOLE SIZE +0.1 / -0.0	D(mm) +0.0 / -0.1	L(mm) ±0.4	HD(mm) ±0.3	HT(mm) +0.15 / -0.05	GRIP RANGE
HBM4	M4X0.7	6.1	5.9	10.7	9.0	0.9	0.5~2.5
HBM5	M5X0.8	7.1	6.9	13.7	10.0	0.9	0.5~3.0
HBM6	M6X1.0	9.1	8.9	16.0	13.0	1.5	0.5~3.3
HBM8	M8X1.25	11.1	10.9	18.0	16.0	1.5	0.5~3.3
HBM10	M10X1.5	13.1	12.9	21.0	19.0	2.0	0.5~3.5

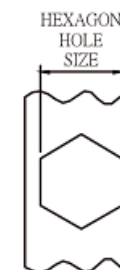
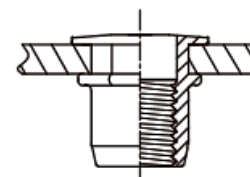
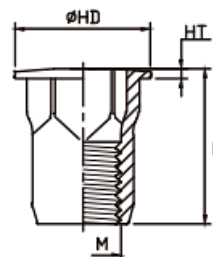
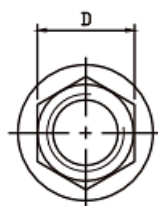

## HHB SERIES LARGE FLANGE , OPEN END

PART NO.	THREAD SIZE	HOLE SIZE +0.1 / -0.0	D(mm) +0.0 / -0.1	L(mm) ±0.4	HD(mm) ±0.3	HT(mm) +0.15 / -0.05	GRIP RANGE
HHBM4	M4X0.7	6.35	6.25	10.5	9.5	0.68	0.5~2.0
HHBM5	M5X0.8	7.20	7.0	11.6	9.9	0.68	0.5~3.3
HHBM6	M6X1.0	9.60	9.4	15.4	12.9	0.76	0.5~3.5
HHBM8	M8X1.25	12.70	12.6	18.4	16.5	0.89	0.5~3.8
HHBM10	M10X1.5	12.70	12.6	18.4	16.5	0.89	0.5~3.8
PART NO.	THREAD SIZE	HOLE SIZE +0.004 / -0.0	D(inch) +0.0 / -0.004	L(inch) ±0.015	HD(inch) ±0.012	HT(inch) +0.006 / -0.002	GRIP RANGE
HHB832	UNC 8-32	.250	.246	.413	.374	.027	0.02~0.080
HHB1024	UNC 10-24	.280	.276	.457	.390	.027	0.02~0.130
HHB1032	UNF 10-32	.280	.276	.457	.390	.027	0.02~0.130
HHB420	UNC 1/4-20	.378	.370	.606	.508	.030	0.027~0.165
HHB518	UNC 5/16-18	.500	.496	.724	.650	.035	0.027~0.150
HHB616	UNC 3/8-16	.500	.496	.724	.650	.035	0.027~0.150



## HHS SERIES SMALL FLANGE , OPEN END

PART NO.	THREAD SIZE	HOLE SIZE +0.1 / -0.0	D(mm) +0.0 / -0.1	L(mm) ±0.4	HD(mm) ±0.3	HT(mm) +0.15 / -0.05	GRIP RANGE
HHSM4	M4X0.7	6.45	6.35	10.4	7.0	0.4	0.5~2.0
HHSM5	M5X0.8	7.20	7.1	11.8	8.0	0.6	0.5~3.0
HHSM6	M6X1.0	9.60	9.5	14.6	10.6	0.6	0.5~3.0
HHSM8	M8X1.25	10.60	10.5	16.0	11.5	0.6	0.5~3.5
HHSM10	M10X1.5	12.70	12.6	18.5	14.0	0.6	0.7~3.8

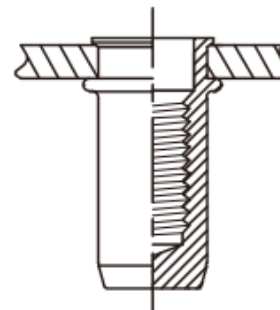
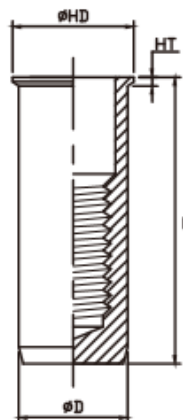

## USS-C SERIES

## SMALL FLANGE , CLOSED END ( ~K = Knurled )

PART NO.	THREAD SIZE	HOLE SIZE +0.1 / -0.0	D(mm) +0.0 / -0.1	L(mm) ±0.4	HD(mm) ±0.3	HT(mm) +0.15 / -0.05	GRIP RANGE
USSM4-C/USSM4K-C	M4X0.7	6.4	6.3	14.9	7.3	0.5	0.5~2.5
USSM5-C/USSM5K-C	M5X0.8	7.2	7.1	20.20	8.1	0.5	0.5~2.5
USSM6-C/USSM6K-C	M6X1.0	9.6	9.5	23.40	10.5	0.5	1.0~4.0
USSM8-C/USSM8K-C	M8X1.25	10.6	10.5	23.60	11.5	0.5	1.0~4.0
USSM10-C/USSM10K-C	M10X1.5	12.8	12.7	28.20	13.7	0.5	1.0~4.0
PART NO.	THREAD SIZE	HOLE SIZE +0.004 / -0.0	D(inch) +0.0 / -0.004	L(inch) ±0.015	HD(inch) ±0.012	HT(inch) +0.006 / -0.002	GRIP RANGE
USS632-C/USS632K-C	UNC6-32	0.253	0.249	0.59	0.289	0.02	0.02~0.10
USS832-C/USS832K-C	UNC8-32	0.253	0.249	0.59	0.289	0.02	0.02~0.10
USS1024-C/USS1024K-C	UNC10-24	0.284	0.280	0.80	0.320	0.02	0.02~0.10
USS1032-C/USS1032K-C	UNF10-32	0.284	0.280	0.80	0.320	0.02	0.02~0.10
USS420-C/USS420K-C	UNC1/4-20	0.378	0.374	0.92	0.414	0.02	0.04~0.15
USS518-C/USS518K-C	UNC5/16-18	0.420	0.414	0.93	0.456	0.02	0.04~0.15
USS616-C/USS616K-C	UNC3/8-16	0.504	0.500	1.11	0.540	0.02	0.04~0.15



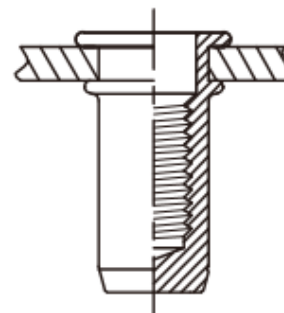
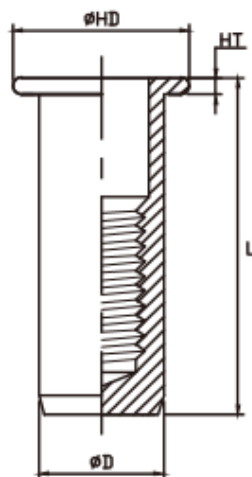

## EUB-C SERIES

## FLAT HEAD, CLOSED END ( ~K = Knurled )

PART NO.	THREAD SIZE	HOLE SIZE +0.1 / -0.0	D(mm) +0.0 / -0.1	L(mm) $\pm 0.4$	HD(mm) $\pm 0.3$	HT(mm) +0.15 / -0.05	GRIP RANGE
EUBM4-C/EUBM4K-C	M4X0.7	6.1	6.0	16.60	9.0	0.8	0.5~2.5
EUBM5-C/EUBM5K-C	M5X0.8	7.1	7.0	17.50	10.0	1.0	0.5~2.5
EUBM6-C/EUBM6K-C	M6X1.0	9.1	9.0	22.40	13.0	1.5	1.0~3.5
EUBM8-C/EUBM8K-C	M8X1.25	11.1	11.0	27.00	14.5	1.5	1.0~4.0
EUBM10-C/EUBM10K-C	M10X1.5	13.1	13.0	31.20	16.0	1.6	1.0~4.0
PART NO.	THREAD SIZE	HOLE SIZE +0.004 / -0.0	D(inch) +0.0 / -0.004	L(inch) $\pm 0.015$	HD(inch) $\pm 0.012$	HT(inch) +0.006 / -0.002	GRIP RANGE
EUB832-C/EUB832K-C	UNC 8-32	0.240	0.236	0.65	0.354	0.032	0.02~0.10
EUB1024-C/EUB1024K-C	UNC 10-24	0.280	0.276	0.69	0.393	0.040	0.02~0.10
EUB420-C/EUB420K-C	UNC 1/4-20	0.358	0.354	0.88	0.512	0.059	0.04~0.14
EUB518-C/EUB518K-C	UNC 5/16-18	0.437	0.433	1.06	0.571	0.059	0.04~0.16
EUB616-C/EUB616K-C	UNC 3/8-16	0.516	0.512	1.23	0.630	0.063	0.04~0.16

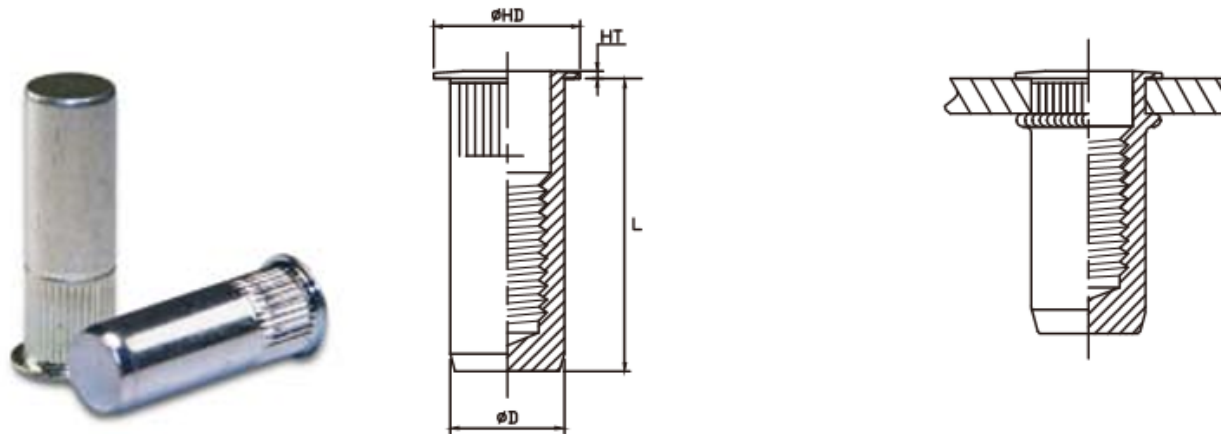

AB-C SERIES		LARGE FLANGE , CLOSED END ( Knurled )					
PART NO.	THREAD SIZE	HOLE SIZE +0.1 / -0.0	D(mm) +0.0 / -0.1	L(mm) ±0.4	HD(mm) ±0.3	HT(mm) +0.15 / -0.05	GRIP RANGE
ABM4-C	M4X0.7	6.8	6.75	18.8	9.90	0.76	0.5~2.0
ABM5-C	M5X0.8	7.6	7.55	25.15	10.10	0.76	0.5~3.3
ABM6-C	M6X1.0	10.0	9.95	30.23	12.70	0.76	0.7~4.0
ABM8-C	M8X1.25	13.5	13.45	35.31	17.00	0.89	0.7~4.0
ABM10-C	M10X1.5	13.5	13.45	35.31	17.00	0.89	0.7~4.0
PART NO.	THREAD SIZE	HOLE SIZE +0.004 / -0.0	D(inch) +0.0 / -0.004	L(inch) ±0.015	HD(inch) ±0.012	HT(inch) +0.006 / -0.002	GRIP RANGE
AB632-C	UNC 6-32	.266	.265	0.74	.375	.03	0.02~0.08
AB832-C	UNC 8-32	.266	.265	0.74	.375	.03	0.02~0.08
AB1024-C	UNC 10-24	.297	.296	0.99	.400	.03	0.02~0.13
AB1032-C	UNF 10-32	.297	.296	0.99	.400	.03	0.02~0.13
AB420-C	UNC 1/4-20	.391	.390	1.19	.500	.03	0.027~0.150
AB518-C	UNC 5/16-18	.531	.530	1.39	.670	.035	0.027~0.150
AB616-C	UNC 3/8-16	.531	.530	1.39	.670	.035	0.027~0.150

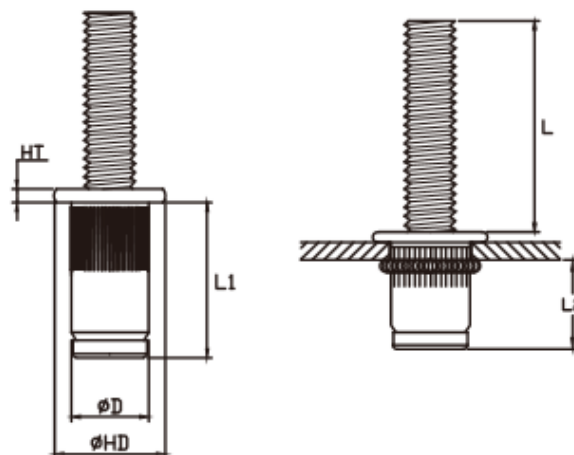

## BOLT RIVET NUTS

PART NUMBER	THREAD SIZE	GRIP RANGE	GRIP CALL OUT	STUD LENGTHS MIN.			HOLE SIZE +0,15 -0,00	HD ±0,10 ±0,25	HT ±0,08	L1 ±0,50	D MAX.	L2 MAX.
				L	L	L						
				CALL OUT	CALL OUT	CALL OUT						
AB 470-B	M4X0,7	0,50-2,00	2.0	12,0	15,0	20,0	6,75	9,91	0,76	12,32	6,73	9,15
AB 470-BL	M4X0,7	2,00-3,30	3.3	10,7	13,7	18,7	6,75	9,91	0,76	13,59	6,73	9,15
AB 580-B	M5X0,8	0,50-3,30	3.3	12,0	15,0	20,0	7,60	10,54	0,76	13,84	7,52	9,65
AB 580-BL	M5X0,8	3,30-5,70	5.7	9,6	12,6	17,6	7,60	10,54	0,76	16,64	7,52	9,65
AB 610-B	M6X1,0	0,70-4,20	4.2	15,0	20,0	25,0	10,00	12,70	0,76	17,02	9,91	11,81
AB 610-BL	M6X1,0	4,20-6,60	6.6	12,6	17,6	22,6	10,00	12,70	0,76	19,56	9,91	11,81
AB 8125-B	M8X1,25	0,70-3,8	3.8	16,0	22,0	28,0	13,50	17,40	0,89	20,57	13,46	14,10
AB 8125-BL	M8X1,25	3,8-7,90	7.9	11,9	17,9	23,9	13,50	17,40	0,89	23,50	13,46	12,96
AB 1015-B	M10X1,5	0,70-3,8	3.8	20,0	25,0	30,0	13,50	17,40	0,89	20,57	13,46	14,10
AB 1015-BL	M10X1,5	3,8-7,90	7.9	15,9	20,9	25,9	13,50	17,40	0,89	23,50	13,46	12,96



# QUALITY PROCESS

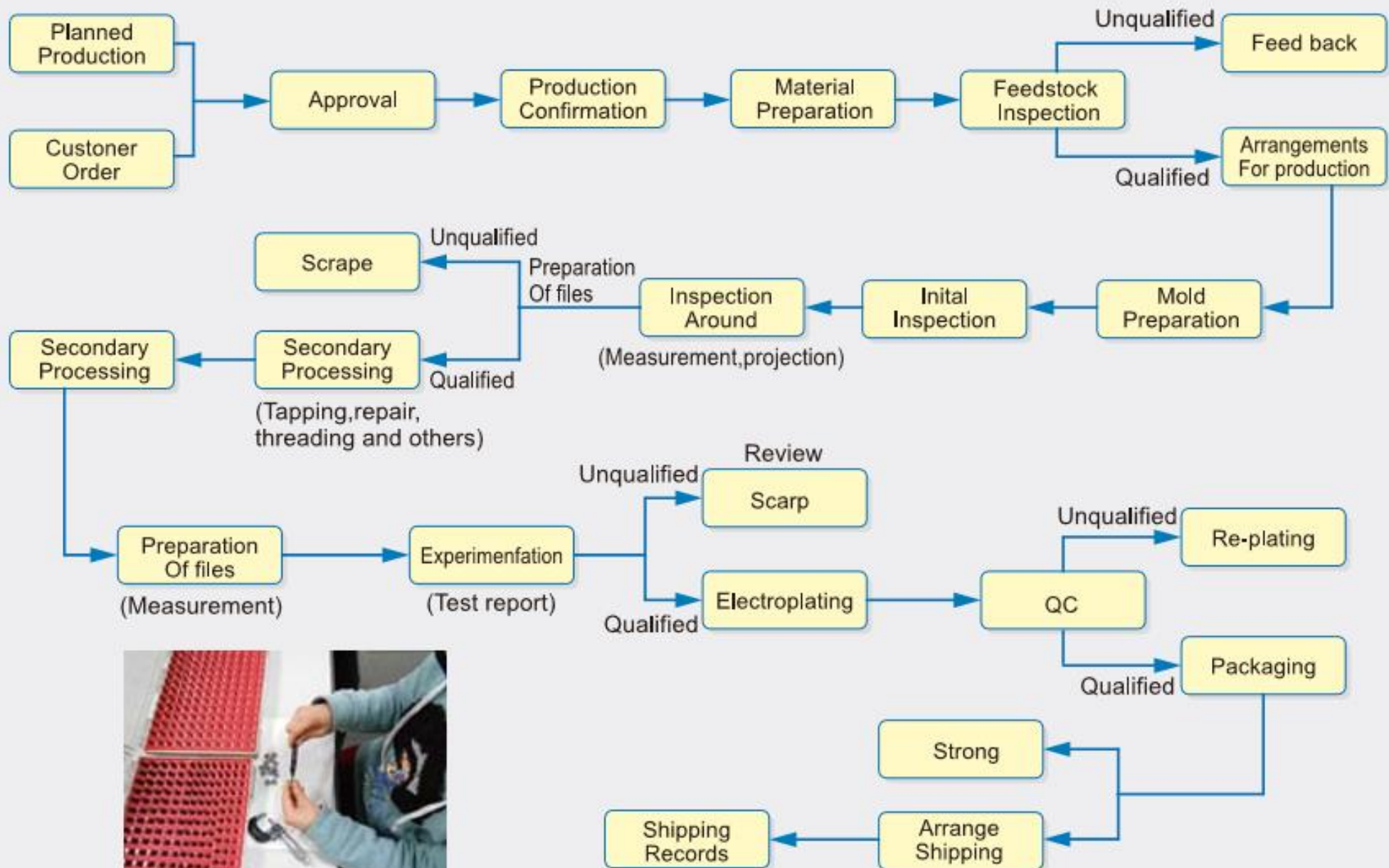

## Special Parts



## CNC Parts



## Press Components

